

# FR05M

MULTI-FUNCTION BIOMETRIC TIME ATTENDANCE TERMINAL



## FR05M

FR05M is a Linux operating system attendance access terminal with multiple identification methods, it supports 5 types of authentication methods: face, fingerprint, palm print, card and password, and supports 10 combinations of authentication methods; FR05M uses RGB & IR dual camera identification, supports fast identification within 0.5~4 meters, and supports nighttime fill light, mask Detection and live body detection function. FR05M can record 5000 groups of identity information and 1,000,000 attendance records, and supports data export.

## Specifications

|                           |   |
|---------------------------|---|
| Dimension                 | 90*28*189mm (device only), 240*140*73mm (package box) |
| Weight                    | 800g (device only), 1300g (gross weight)              |
| Screen                    | 4.3" Touch Screen                                     |
| Screen Resolution         | 480*272   |
| Operating Temperature     | -15°C ~45°C   |
| Working Humidity          | 20%~90%   |
| Operating Voltage Working | DC 12V  |
| Current                   | Standby current 330mA, operating current 350mA        |
| Installation method       | Wall mounting   |

## Camera

|                 |  |
|-----------------|--|
| Dual Camera     | 1.0M RGB camera + 1.0 Infrared camera  |
| Auto fill light | Support infrared fill light, support in the dark environment automatically light up the fill light |

## Hardware Parameters

|     |       |
|-----|-------|
| RAM | 256MB |
| ROM | 4GB   |
| OS  | Linux |

## Interface

|               |   |
|---------------|---|
| USB Interface | 1*USB 2.0 (Support data export)                     |
| Power         | 1*DC port   |
| Wiegand       | Wiegand 26/34 output (reserved for expansion RS485) |
| Network       | Wired TCP/IP, Support C/S LAN communication         |

## Functions

|                          |   |
|--------------------------|---|
| Registration Method      | Local registration, U disk import, network download of user data  |
| Verification Comparison  | Facial recognition, palm print recognition, fingerprint recognition, password, ID card recognition (expandable IC card or other card types)   |
| Data Capacity            | 5000 facial data, 3000 fingerprint data, 3000 palm print data, 5000 passwords, 5000 cards   |
| Attendance Logs Capacity | 1,000,000 logs  |
| Accuracy Rate            | 99.70%  |
| Recognition Speed        | Fastest 0.3 seconds, support multi-person identification and combination recognition  |
| Recognition Distance     | 0.5m-4.0m (open live identification)  |
| Live Body Detection      | Double camera anti-counterfeiting, eliminate all kinds of photos, videos on various carriers fraud  |
| Recognition Principle    | Based on infrared recognition technology, the product collects palm vein images to achieve palm verification anti-fake technology; the product adopts the world's first optical waterproof fingerprint reader, the first time to achieve optical fingerprint waterproof application |

### Software Function

|                                 |   |
|---------------------------------|---|
| No software attendance          | U disk export attendance records, statistical Excel reports                 |
| Classes and Scheduling          | Support local shift setting, U disk import scheduling table                 |
| Back Office Management Software | Support computer software to link equipment management data through network |
| Voice Broadcast and ringing     | Support display name, built-in off-duty ringing                             |

### Access Control Function

|  |
|--|
| Door open alarm  |
| Forced door opening alarm                                  |
| Alarm linkage and output                                   |
| One set of door opening signal and one set of alarm signal |
| Time period authority control                              |

### More Details



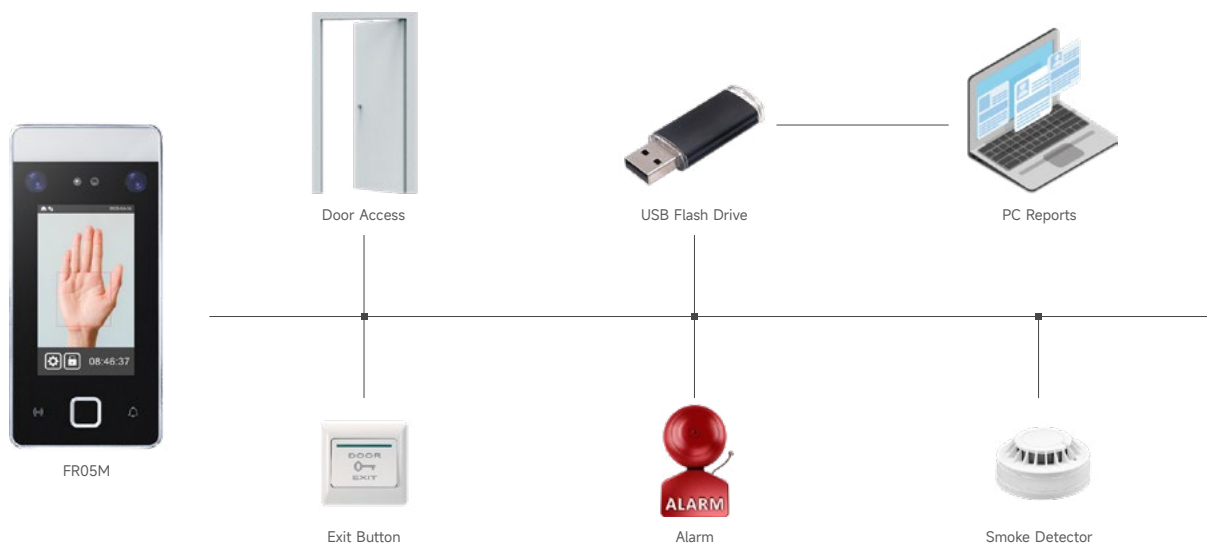
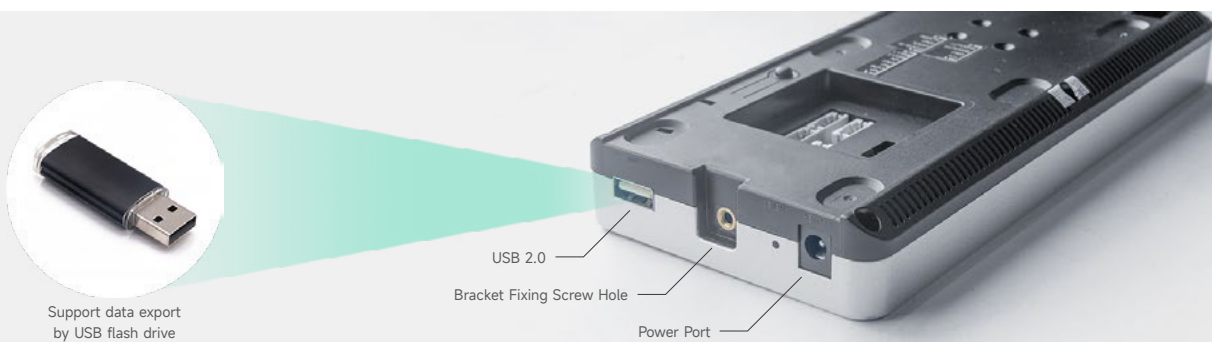
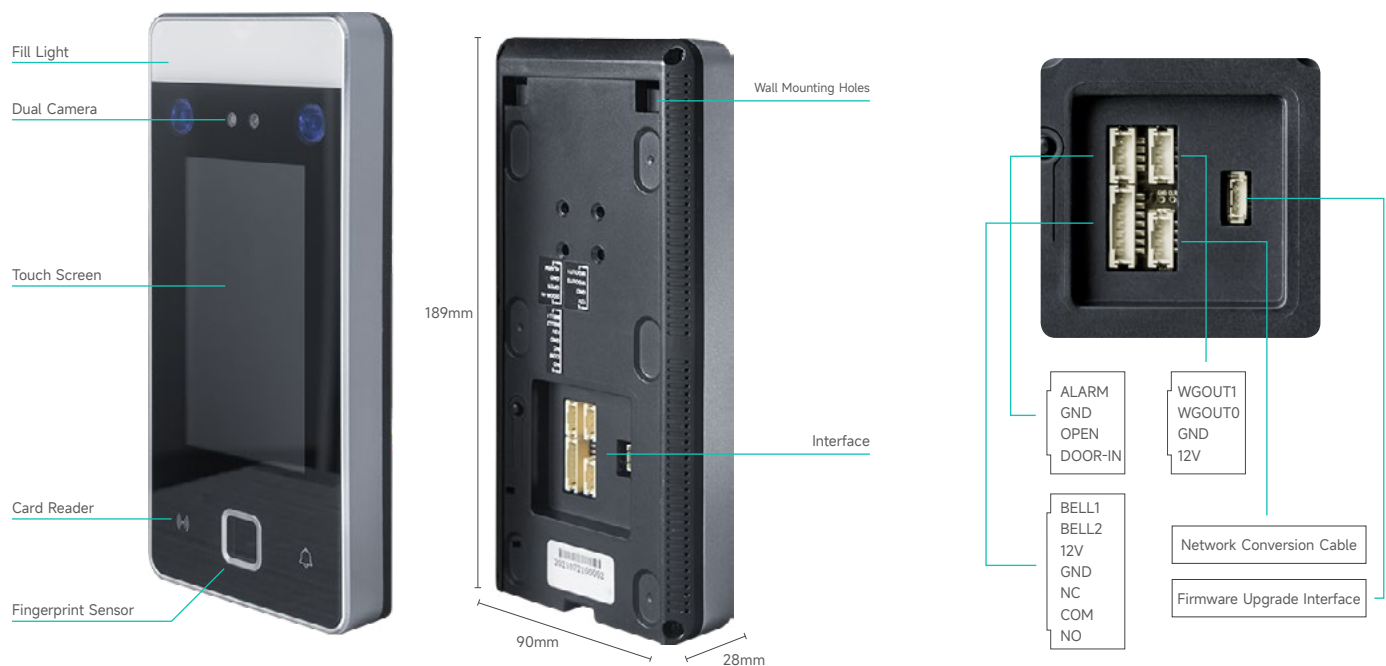

**Head-quarter: Chongqing Huifan Technology Co., Ltd.**

◆ D-13, Dongli International Building Longtousi, Yubei District, Chongqing, China.

**Branch: Shenzhen BIO Technology Co., Ltd.**

◆ Room 301-305, No.32, Jianlong Industrial Zone, Yuanshan, Longgang District, Shenzhen, China



www.hfsecurity.cn



www.hfeco.com



YouTube